

ELEVATE YOUR **CHICAGO NASCAR** EXPERIENCE

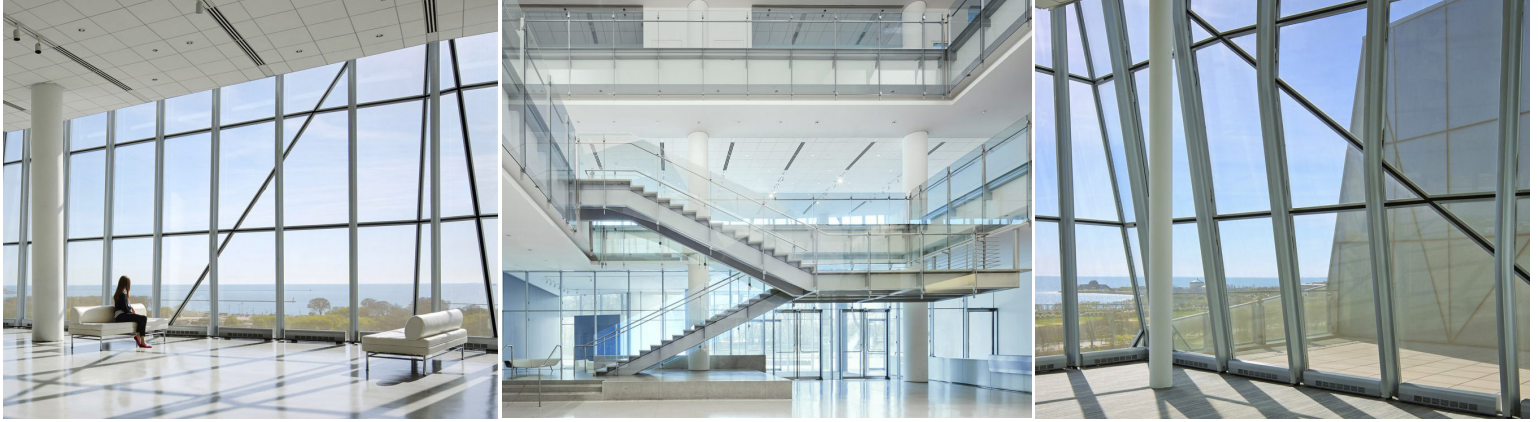

- Host your group at the eRacing Association Turn 7 Skydeck
- Experience Chicago's first NASCAR street race from an elevated venue
- Indoor space overlooks the entire race, Chicago lakefront & skyline
- Designed for corporate groups of 20-200
- Fully catered & open bar
- Private viewing and customized packages available
- Venue sponsorship opportunities available

Event partners:

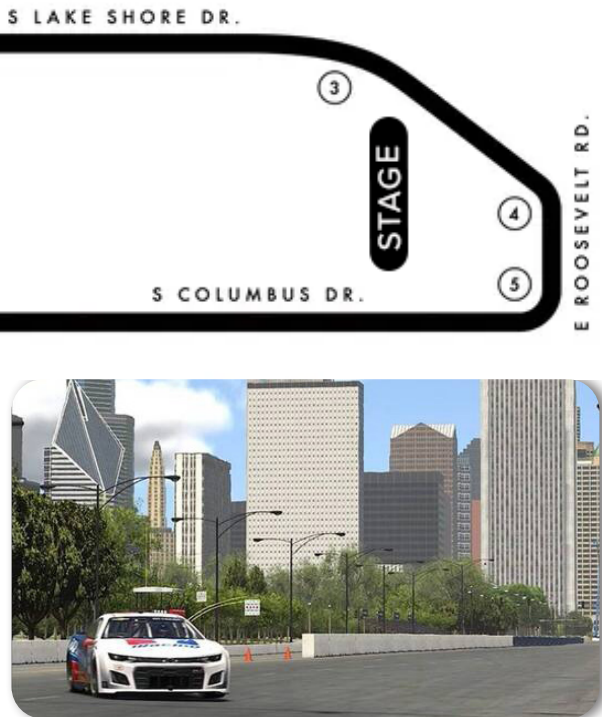
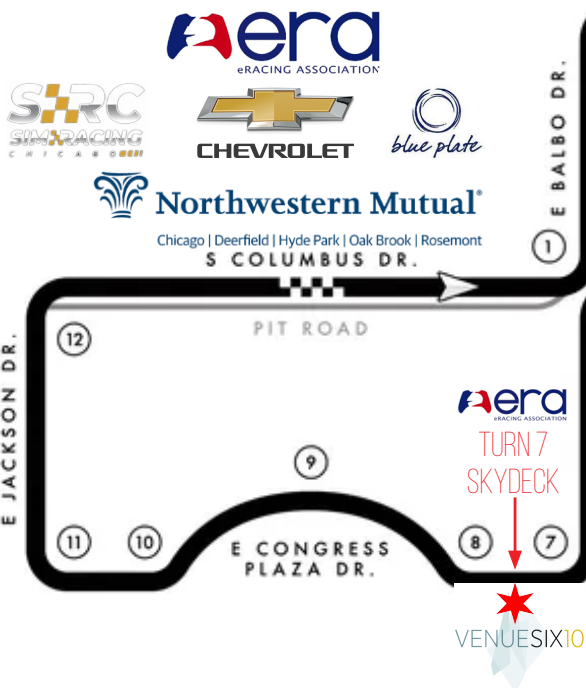

RACING AND MUSIC FESTIVAL TAKES PLACE JULY 1-2, 2023

FOR PRICING AND AVAILABILITY, CONTACT: EVENT@CHICAGORACEDAY.COM

Branding Locations: _____

1st Floor – Main Lobby & Entrance

<https://venuesix10.com>

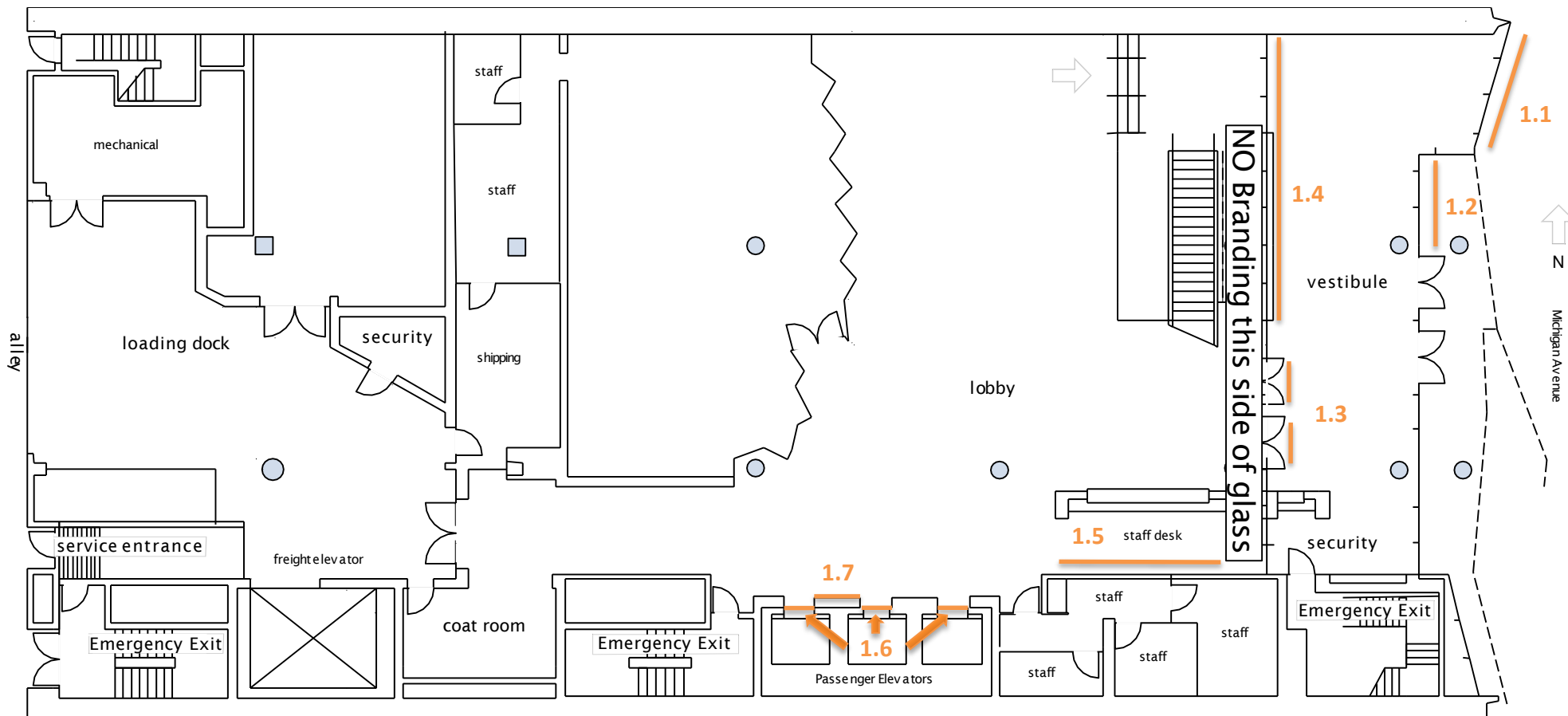

Location	Branding Opportunities	Pricing and Dimensions
1.1	Building Exterior (north)	\$ 150,000 ~198"W x 107"H (4 panels) - Partially visible on national TV broadcast
1.2	Building Exterior (north)	\$ 75,000 ~125"W x 107"H (2.5 panels) - Partially visible on national TV broadcast
1.3	Entrance Doors	\$ 50,000 per set of doors – 34"W x 97.5"H (branding must not block sight lines)
1.4	Vestibule Window (East Side Only)	\$ 25,000 per panel – all 50.5"W; 5 panels @ 68"H; 2.5 panels @ 88.5"H
1.5	Registration Rear Wall	\$ 15,000 (includes Banner removal) – 385"W x 144"H
1.6	Elevator Doors	\$ 15,000 per car fee – overall 42"W x 84"H (center door opening); stainless area above = 42"W x 24"H
1.7	Elevator Directory	\$ 5,000 (small 42"W x 6"H OR full coverage = 61.5"W x 109"H)

Branding locations: _____

2nd Floor – Landing & Theater

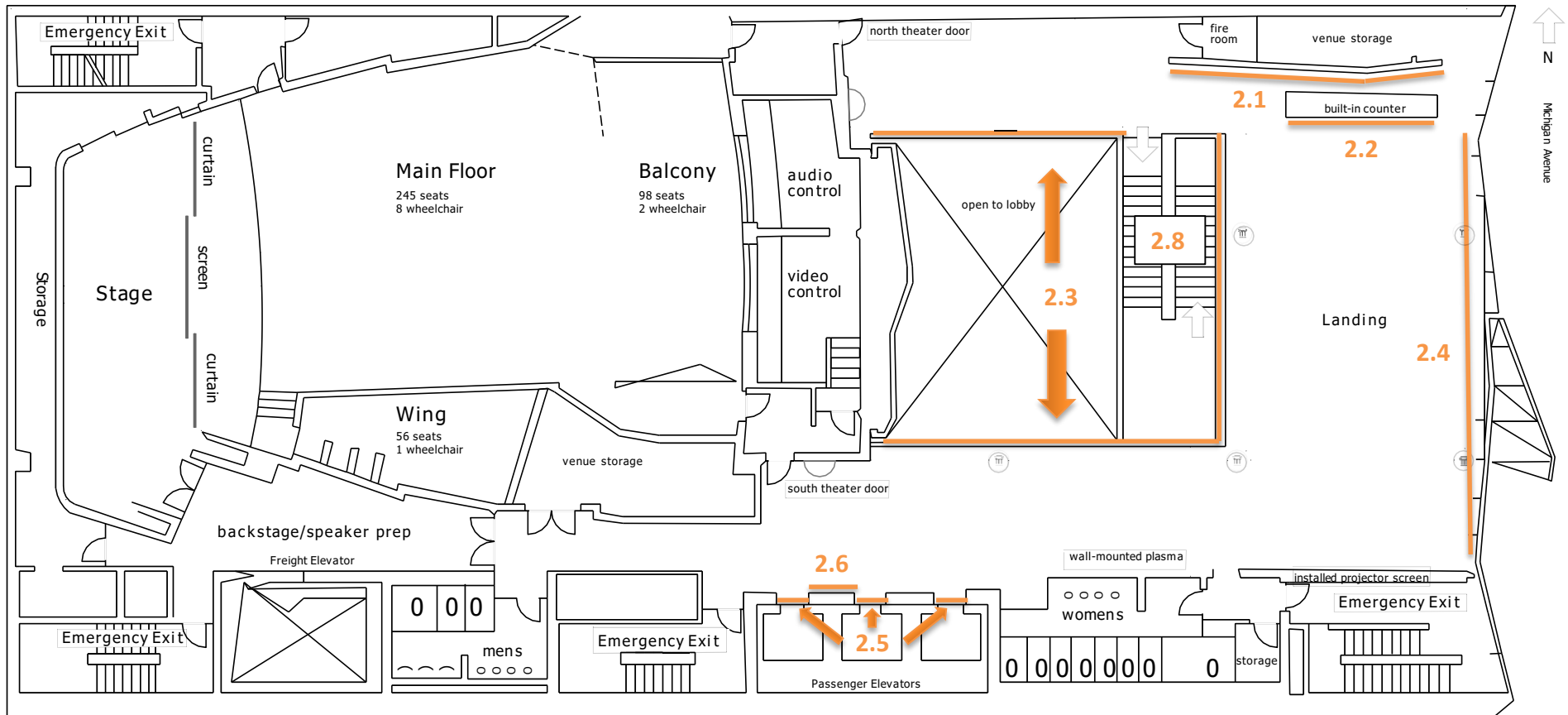
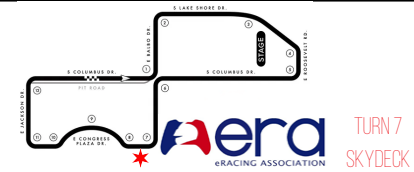

Location	Branding Opportunities	Pricing and Dimensions
2.1	Credenza Wall	\$ 25,000 – 2 sections: 1) 273"W x 95"H; 2) 100"W x 95"H
2.2	Credenza	\$ 15,000 – 3 sections: Overall = ~(203"L x 40"H x 30"D)
2.3	Atrium Glass Surround	\$ 20,000 per panel – average panel = 46"W x 42"H (maximum interior dimensions – must be installed from 2 nd floor)
2.4	Front Window Wall	\$ 20,000 per panel – (measurements vary) average panel = ~(46.5"W x 79.75"H)
2.5	Elevator Door	\$ 15,000 per car – overall 42"W x 84"H (center door opening)
2.6	Elevator Directory	\$ 5,000 (small 42"W x 6"H OR full coverage = 61"W x 86"H)
2.8	Stair Fronts	\$ 7,500 (fee includes both sets of stairs – 1 st set = 18 steps; 2 nd set = 15 steps); front risers = 60"W x 5.75"H each

Branding locations:

4th Floor – Classrooms

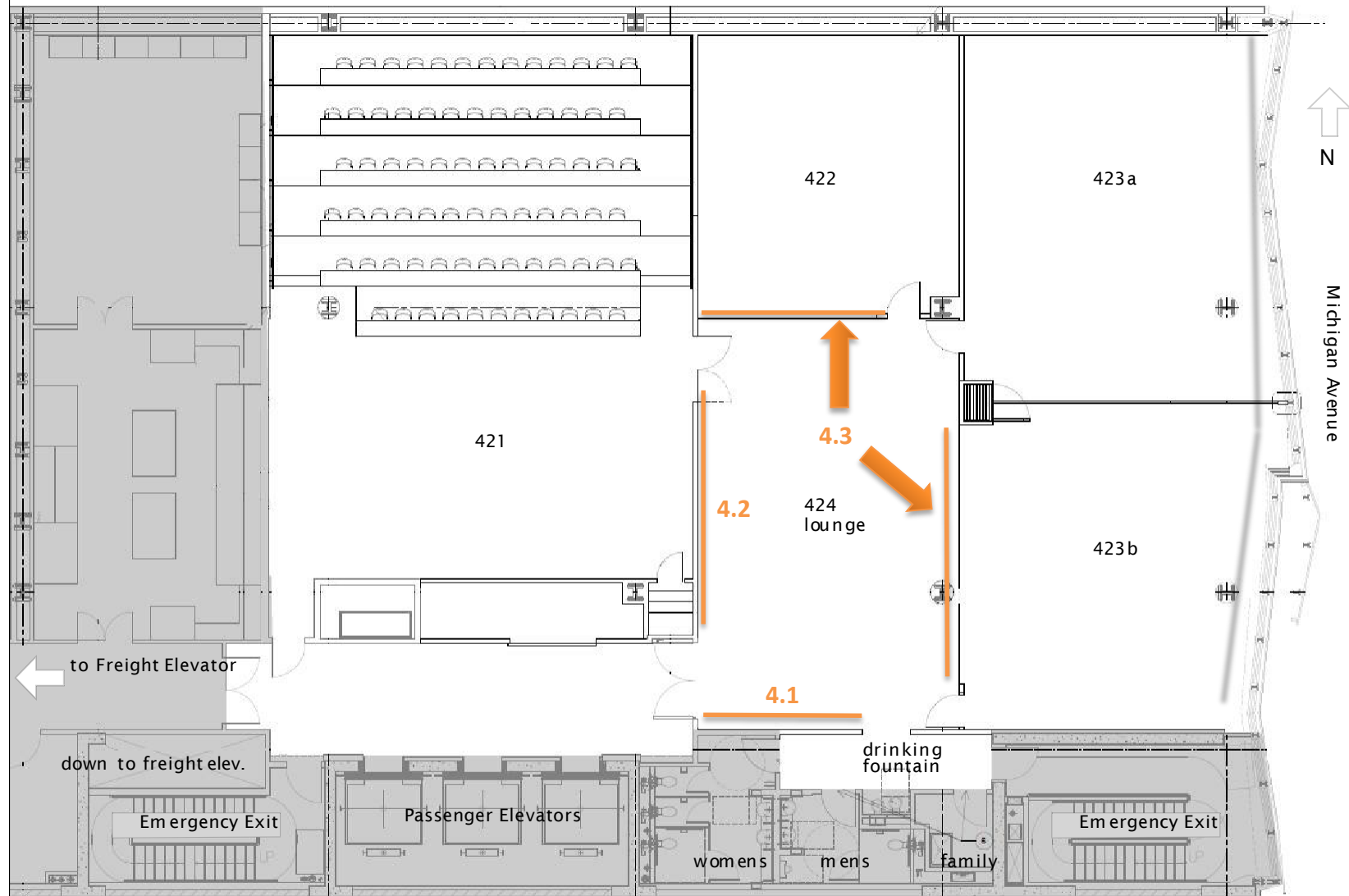

Location	Branding Opportunities	Pricing and Dimensions
4.1	South Lounge Wall	\$ 5,000 – 179"W x 107"H
4.2	West Lounge Wall	\$ 5,000 – 262"W x 116"H (phone and directory may not be removed)
4.3	Glass in lounge, priced per pane	\$ 5,000 per panel – all panels 120"H (widths vary); approximately 9 panels in total

Branding locations: _____

9th Floor – Crown Family Great Hall

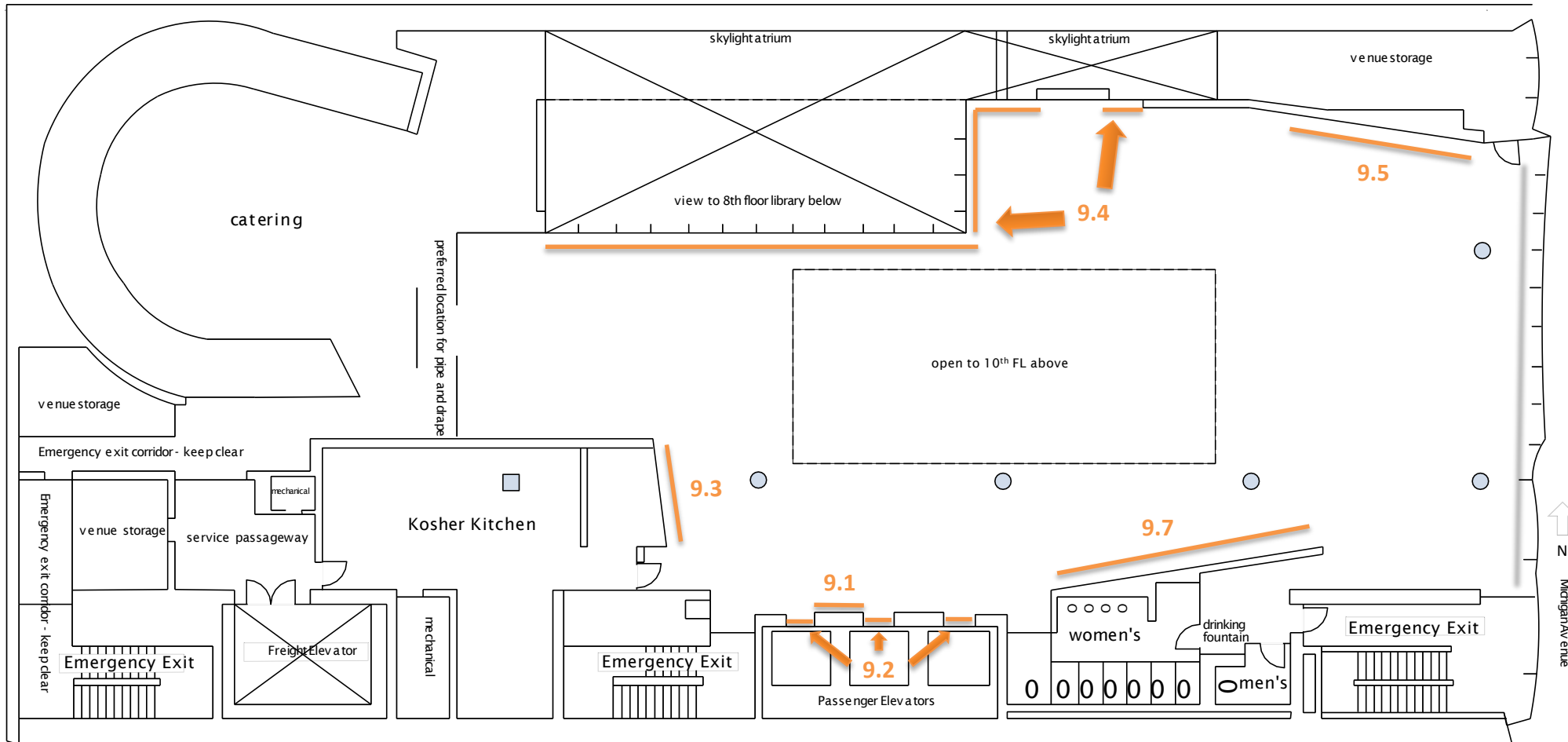

Location	Branding Opportunities	Pricing and Dimensions
9.1	Elevator Directory	\$ 5,000 (small 42"W x 6"H OR Full Sign coverage = 61"W x 86"H)
9.2	Elevator Doors	\$ 15,000 per car – overall 42"W x 84"H (center door opening)
9.3	West Wall	\$ 15,000 – 156"W x 192"H
9.4	North Atrium Window Wall	\$ 15,000 per glass panel – most panels = 45.5"W x 83"H
9.5	Venue Storage Wall	\$ 20,000 – 212"W x 168"H
9.7	South Angled Wall	\$ 30,000 – 376"W x 192"H (existing text may not be affected)

Branding locations:

\$/day

10th Floor – Gallery 10 & Landmark Room

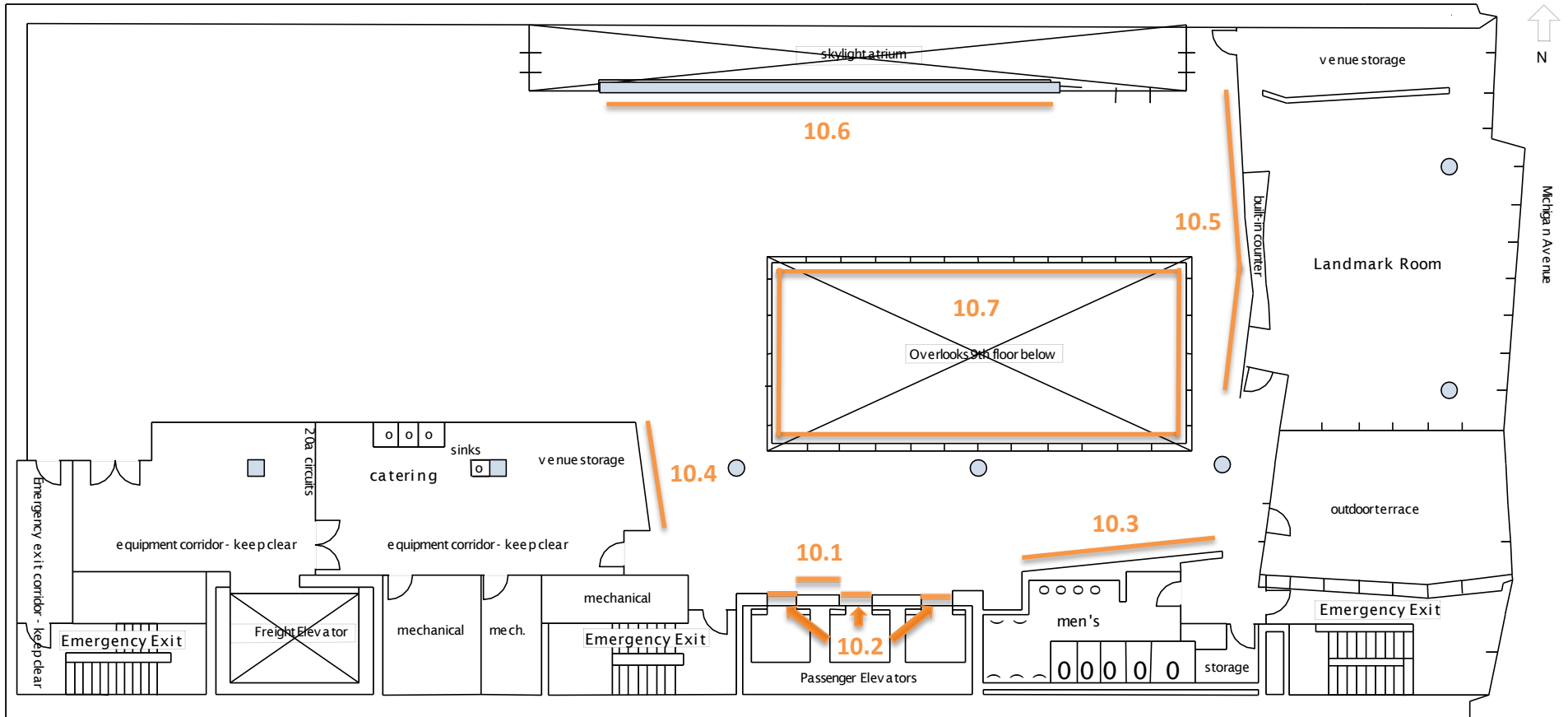

Location	Branding Opportunities	Pricing and Dimensions
10.1	Elevator Directory	\$ 2,500 (small 42"W x 6"H OR Full Sign coverage = 61"W x 86"H)
10.2	Elevator Doors	\$ 5,000 per car fee – overall 42"W x 84"H (center door opening)
10.3	Southeast Angled Wall	\$ 25,000 – 274"W x 126"H
10.4	Southwest Angled Wall	\$ 20,000 – 156"W x 192"H
10.5	East Wall	\$ 35,000 – 2 sections: 1) 280"W x 126"H; 2) 146"W x 126"H
10.6	North Wall	\$ 35,000 – 684"W x 126"H (includes artwork removal fee)
10.7	Northwest Wall Atrium Glass Surround	\$ 10,000 per glass panel – average panel = 46"W x 42"H

Venue Branding Contact Sheet - Floor 1



Venue Branding Contact Sheet - Floor 2

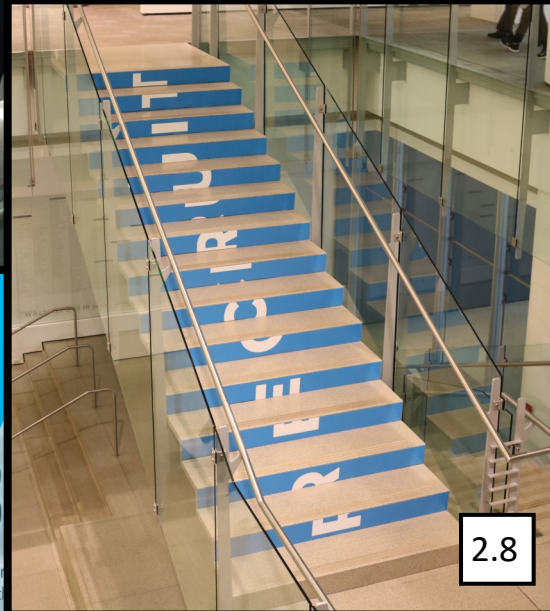

Venue Branding Contact Sheet - Floor 9

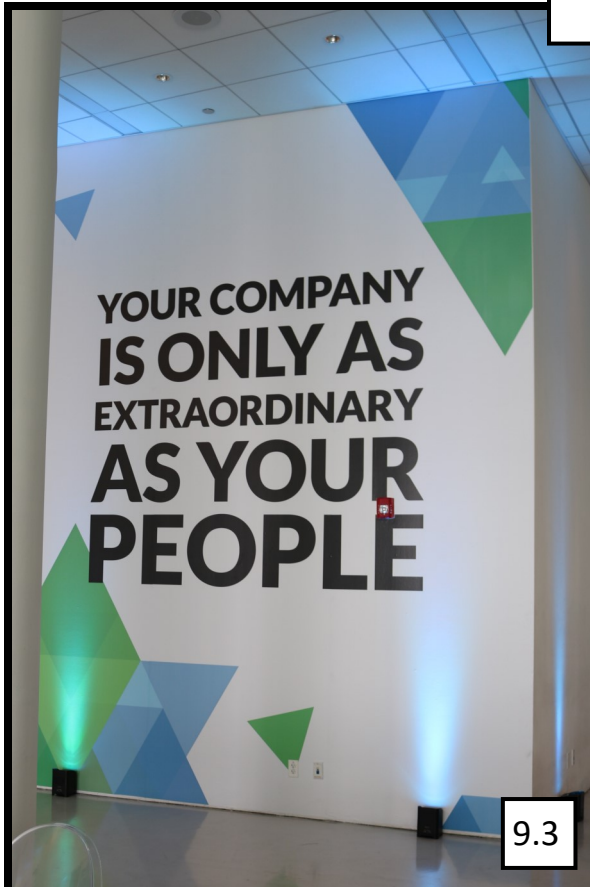

Venue Branding Contact Sheet - Floor 10

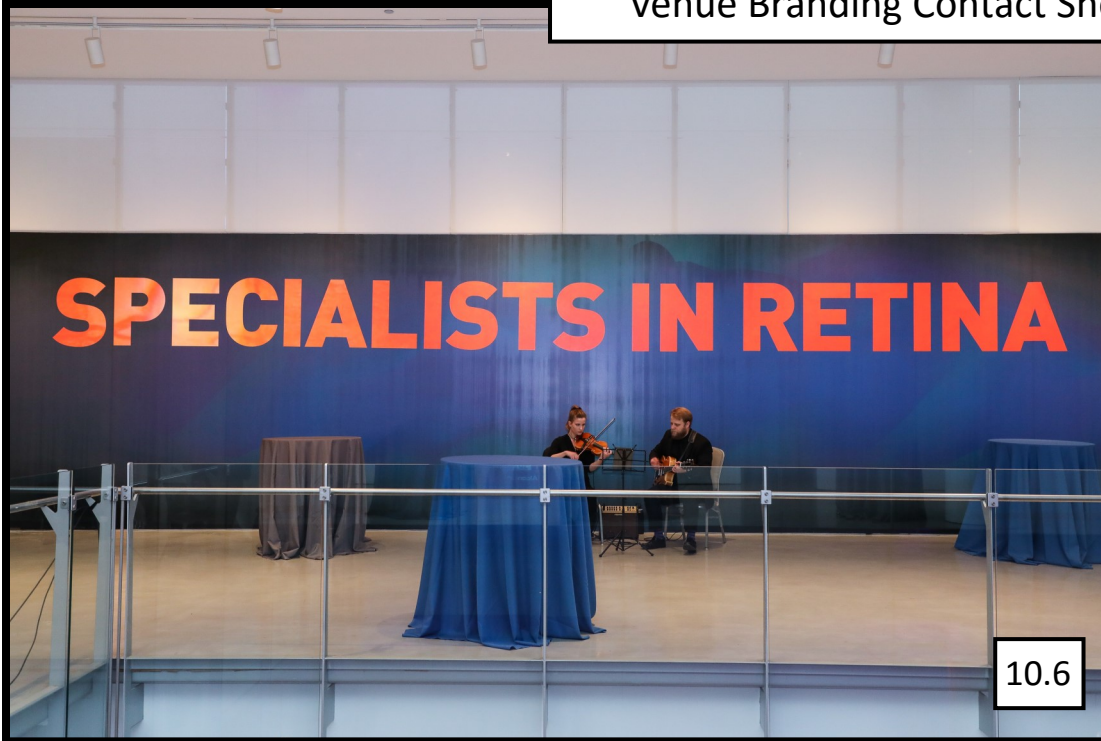

10.6



10.1 & 10.2



10.5

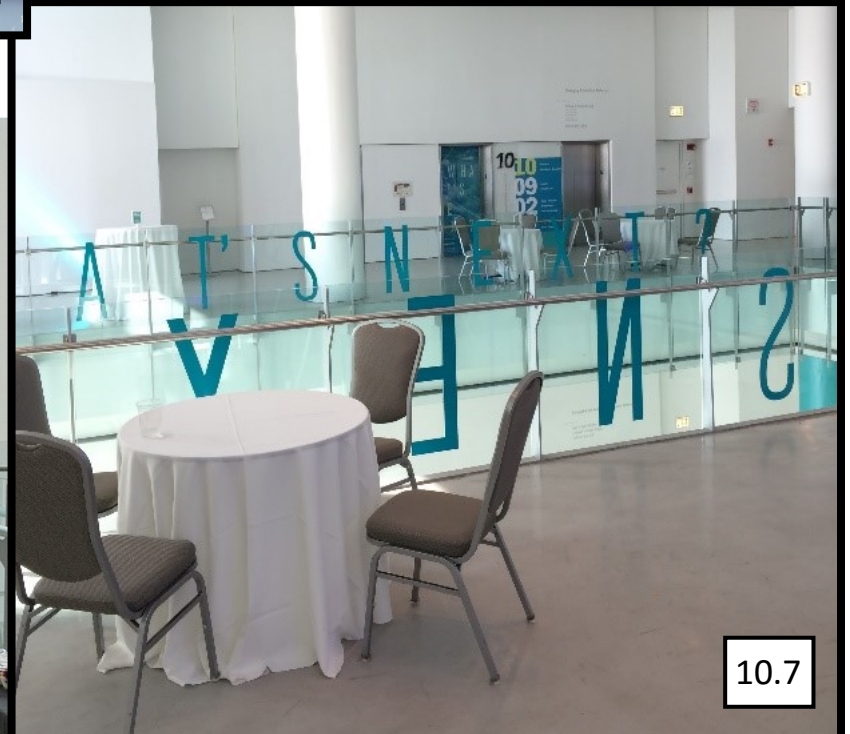

10.7